

Comments: Fasteners must embed into nailer 25mm (1") min.
 Membrane must be fully adhered from roof edge to first row of membrane fasteners.

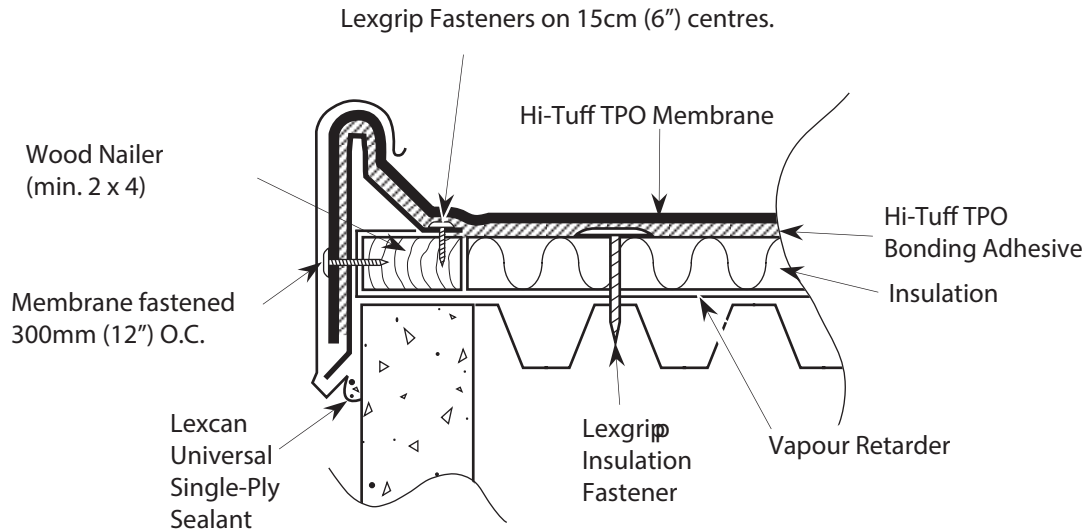

**Roof Edge
 (Edge System)
 Roofing System Detail**

**Scale: Not to scale
 Date: August, 2016
 Detail No.: H-S-201**



Comments: Fasteners must embed into nailer 25mm (1") min.
 Membrane must be fully adhered from roof edge to first row of membrane fasteners.



**Roof Edge
 (Edge System)
 Roofing System Detail**

Scale: Not to scale
 Date: August, 2016
 Detail No.: H-S-201